

Type **TK16 CNG**

CNG Fuelling Nozzle

for cars at self-service fuelling stations



General

DESCRIPTION

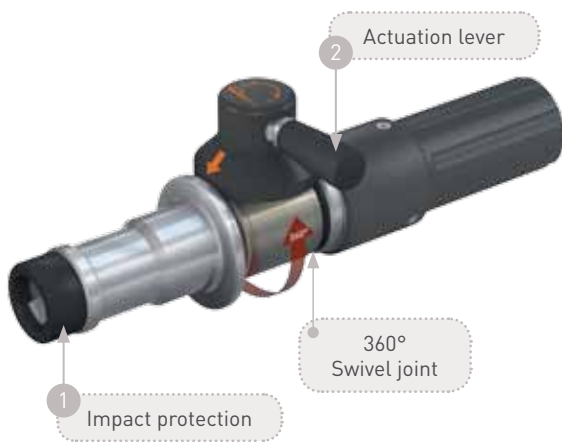

Features

- Super light ➔ only 1,750 grams
- Compatible with receptacles acc. to NGV1 standard and ISO 14469-1 and 3
- WEH® EASY-TURN 360° swivel joint for actuation lever
- Easy operation
- Extremely high flow rate ➔ short filling times
- Recirculation of the vented gas
- Plastic thermal protection
- WEH® Jaw locking mechanism
- Colour coded impact protection (200 bar / 3,000 psi black, 250 bar / 3,600 psi yellow)
- High-grade materials
- Coding for pressure range / gas type

TK16 CNG, the world's most popular NGV1 fuelling nozzle.

Type TK16 CNG is very light in weight and therefore easy to operate. The actuation lever is located on the integrated swivel joint making it easy to rotate into the optimal actuating position. The compact actuation lever needs less effort to actuate the nozzle.

Safety

The TK16 CNG offers optimum safety to the operator.

The fuelling nozzle remains connected to the receptacle until the gas between inlet valve and receptacle is depressurized. To achieve optimum performance it is recommended that the TK16 CNG fuelling nozzle is used with the WEH® TN1 CNG receptacle.

Application

Fuelling nozzle for CNG fast filling of cars at self-service fuelling stations to be used with WEH® TN1 CNG receptacles acc. to NGV1 standard and ISO 14469-1 and 3.

TECHNICAL DATA

Characteristic	Basic version	Options
Nominal bore DN	8 mm	On request
Pressure range	B200 acc. to ISO 14469-1 (P30 acc. to ANSI NGV1) PN = 200 bar (3,000 psi) PS = 300 bar PT = 450 bar (black) B250 acc. to ISO 14469-3 (P36 acc. to ANSI NGV1) PN = 250 bar (3,600 psi) PS = 350 bar PT = 525 bar (yellow)	
Temperature range	-40 °C up to +85 °C (-40 °F up to +185 °F)	On request
Material	Corrosion resistant	On request
Sealing material	Natural gas compatible	On request
Design	With plastic thermal protection and gas recirculation	On request
Weight	1.75 kg (3.86 lbs.)	
Registration	PED97/23/EC: CE0036 The products comply with ANSI NGV1.	

Ordering

ORDERING | Fuelling nozzle TK16 CNG

approx. dimensions (mm)



Part No.	Description	Pressure (PN)	Inlet B (external thread)	Gas recirculation C (external thread)
C1-35299	TK16 CNG	200 bar / 3,000 psi (black)	UNF 9/16"-18*	UNF 7/16"-20*
C1-101084	TK16 CNG	250 bar / 3,600 psi (yellow)	UNF 9/16"-18*	UNF 7/16"-20*

* acc. to SAE J514, 37°

Please see page 20 in catalogue no. 15 onwards for complete hose assemblies consisting of fuelling nozzle, hose set and breakaway coupling.

ACCESSORIES

The following accessories are available for type TK16 CNG:

Dispenser mounting

Mounting for safe attachment of the fuelling nozzle to the dispenser. Optionally with or without switch actuation.
Design: Aluminium, stainless steel

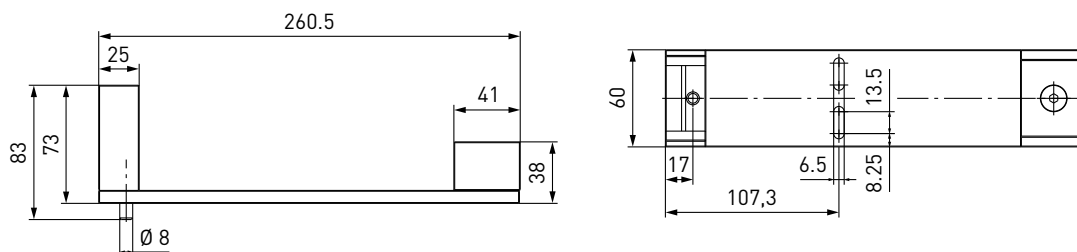

Part No.	Description
C1-51233	Mounting (switch actuated)
C1-51236	Mounting (not switch actuated)

Ordering

Hose sets TK16 CNG - TSA1 CNG (filling and venting hose)

Filling and venting hoses for connecting fuelling nozzle and type TSA1 CNG breakaway coupling, complete with fittings and press-fittings supported by coil spring stubs. Available as single or twin hoses (permanently bonded).

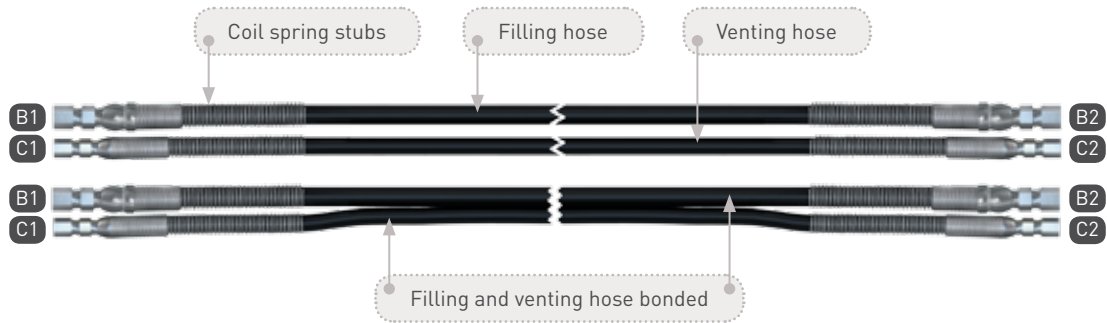

Part No.	Filling hose B1/B2 (internal thread)	Venting hose C1/C2 (internal thread)	Hose length
C1-50487	UNF 9/16"-18*	UNF 7/16"-20*	3 m
C1-42304	UNF 9/16"-18*	UNF 7/16"-20*	4 m
C1-58587	UNF 9/16"-18*	UNF 7/16"-20*	5 m

* acc. to SAE J514, 37°

All designs also available with permanently bonded filling and venting hose. Please contact us!

Hose sets TK16 CNG - TSA2 CNG (filling and venting hose)

Filling and venting hoses for connecting fuelling nozzle / dispenser and type TSA2 CNG inline breakaway coupling, complete with fittings and press-fittings supported by coil spring stubs.

Part No.	Filling hose B1/B2 (internal thread)	Venting hose C1/C2 (internal thread)	Hose length
On request	UNF 9/16"-18*	UNF 7/16"-20*	2.5 0.5 m
On request	UNF 9/16"-18*	UNF 7/16"-20*	3.5 0.5 m
On request	UNF 9/16"-18*	UNF 7/16"-20*	4.5 0.5 m

* acc. to SAE J514, 37°

All designs also available with permanently bonded filling and venting hose. Please contact us!

Conversion Kit

We also offer a conversion kit to fit fuelling hoses with older fittings. The conversion kit consists of one fitting each for the filling and the venting line. The existing TK16 CNG fuelling nozzle fittings must be removed and replaced by the conversion kit fittings.



Part No.	Description	Connection fuelling nozzle	Connection filling hose
W59444	Conversion Kit	UNF 9/16"-18* internal thread	Tube Ø 6
C1-86380	Conversion Kit	UNF 9/16"-18* internal thread	Tube Ø 1/4"

* acc. to SAE J514, 37°

Ordering

Fittings

Stainless steel fittings for connecting the media inlet 'B' to the filling hose or the gas recirculation inlet 'C' to the venting hose.

Part No.	Description	Connection fuelling nozzle	Connection filling hose
C1-79538	Fitting	UNF 9/16"-18* internal thread	UNF 9/16"-18** internal thread
C1-65592	Fitting	UNF 9/16"-18* internal thread	NPT 1/4" internal thread

* acc. to SAE J514, 37°

** acc. to SAE J1926

Please see page 126 in catalogue no. 15 onwards for a detailed overview on all available fittings.

Spare parts

Various parts are available as spares for type TK16 CNG:



Part No.	Description
E80-65895	1 Impact protection (200 bar / 3,000 psi, black)
E80-106824	1 Impact protection (250 bar / 3,600 psi, yellow)
W72504	2 Actuation lever
E99-44923	Maintenance spray

Other products

OTHER PRODUCTS

You will find more products in our current catalogue no. 15



Further information on our homepage
www.weh.com

» Contacting

For queries and further information, please do not hesitate to contact us.

Manufacturer:

WEH GmbH Gas Technology

Josef-Henle-Str. 1
89257 Illertissen / Germany

Phone: +49 7303 95190-0

Fax: +49 7303 95190-9999

eMail: ngvsales@weh.com

www.weh.com